

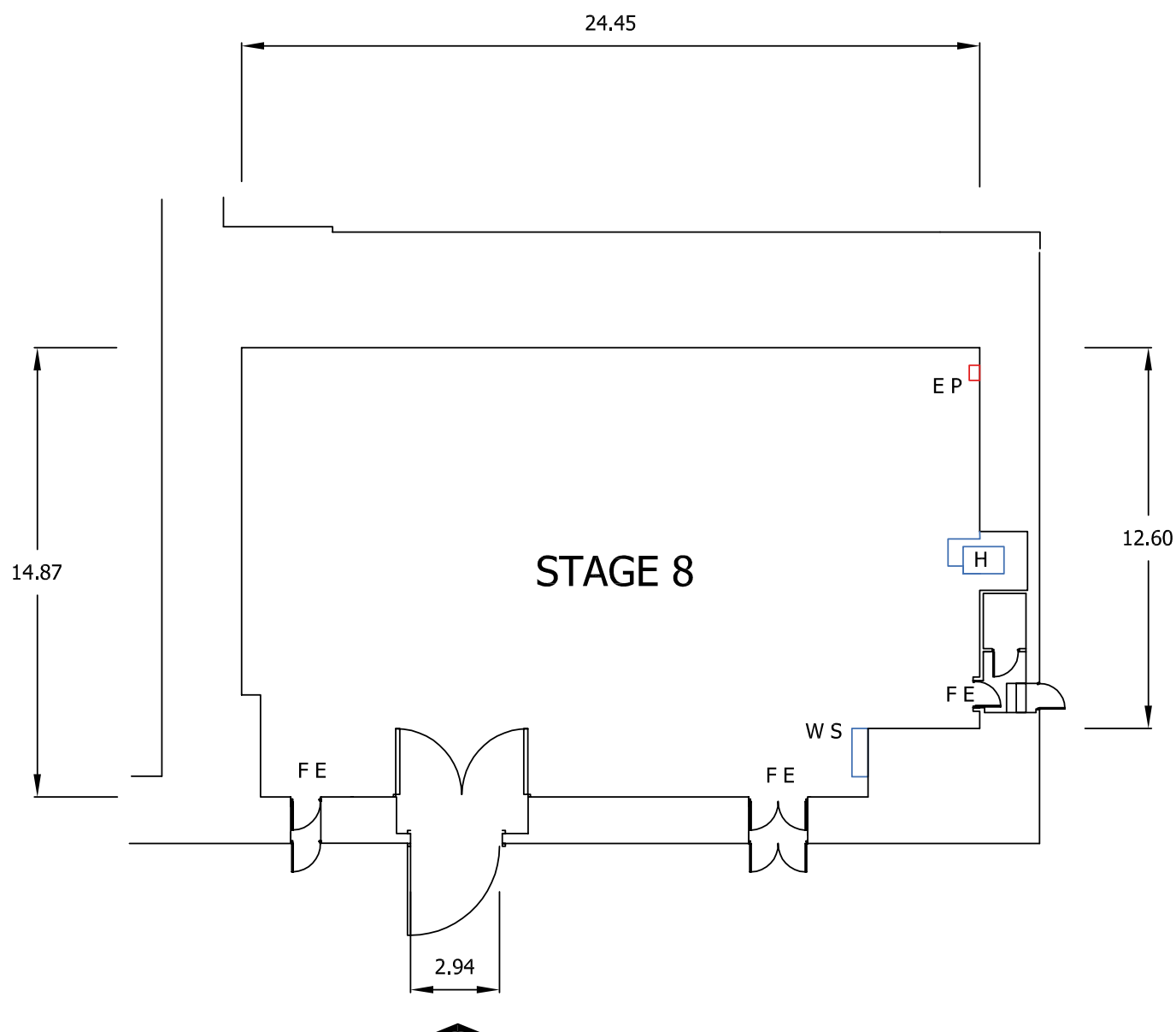

Stage 8



KEY

| | |
|-------------------------------------------------------------------------------------|----------------------|
|  | MAIN ENTRANCE |
| FE | FIRE EXIT |
| EP | ELECTRIC PANEL |
| WS | WATER SUPPLY OR SINK |
| H | HEATER |

STAGE DIMENSIONS

| STAGE 8 | LENGTH | WIDTH | HEIGHT | AREA |
|-------------|--------|--------|--------|-------------|
| Feet/inches | 80'3" | 48'9" | 31'8" | 3,802 sq ft |
| Metres | 24.45m | 14.87m | 9.64m | 353.18 sq m |

Dimensions are not to be scaled from this drawing. Production must verify all dimensions before commencing any works on this stage.

Stage 8

Technical details

| | | | |
|----------------------|--------------------------------------------------|---------------------------------------------------------------------------------|-------------|
| STAGE SIZE | Length | 80' 3" | 24.45 m |
| | Width | 48' 9" | 14.87 m |
| | Height (to runway beams) | 31' 8" | 9.64 m |
| | Area | 3,802 sq ft | 353.18 sq m |
| ELECTRICAL SUPPLY | Maximum electrical load | AC full load Amps 400 3-phase <i>Connection via sequential NRG Powerlock</i> | |
| | Number of 63 Amp sockets | 1 | |
| | Number of 32 Amp sockets | 1 | |
| | Number of 16 Amp sockets | 2 | |
| | Number of 13 Amp sockets | 26 | |
| | Number of 200 Amp supply | 1 | |
| SOUND STAGE | Damped | | |
| BEAM LOADING | 1 Tonne evenly distributed, per beam. 4 x beams. | | |
| WALL ANCHOR POINTS | N/A | | |
| LOADING ACCESS | Dock doors | | |
| FLOOR TYPE | Concrete with wooden overlay | | |
| FLOOR LOADING | N/A | | |
| HEATING | Heated air blower | Yes | |
| WATER ON STAGE | Yes | | |
| TELECOMS & BROADBAND | Available | | |
| FIRE PROTECTION | Sprinkler activation temperature | 68C | |
| | Smoke detectors | No | |
| FIRE EXTINGUISHERS | H2O | 0 | |
| | CO2 | 3 | |
| | Foam | 2 | |
| RED LIGHT AND BELL | Yes, next to entrance | | |
| EXTRACTION | No | | |

